

Section A-A 1:75

ALL DIMENSIONS TO FFL & FINISHED SURFACES

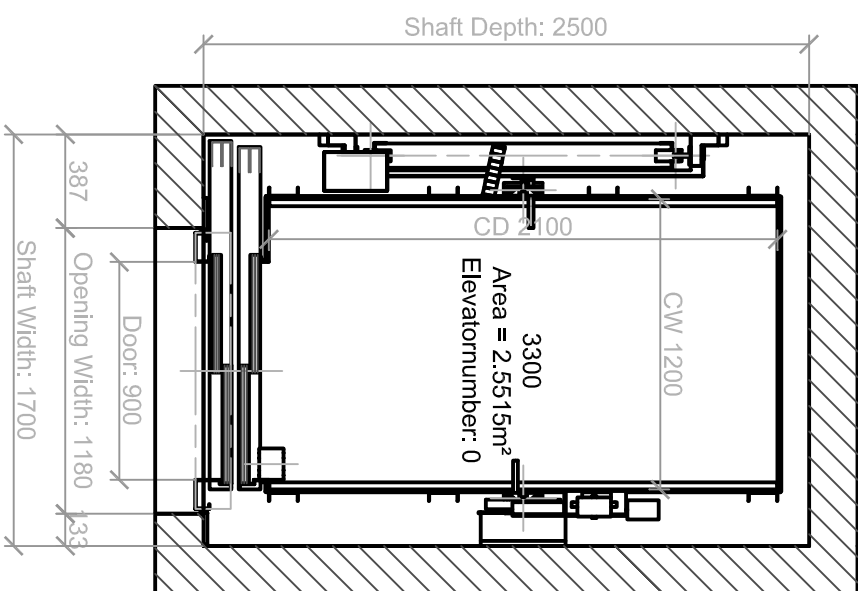

Scale: 1:30
Lift Car Plan

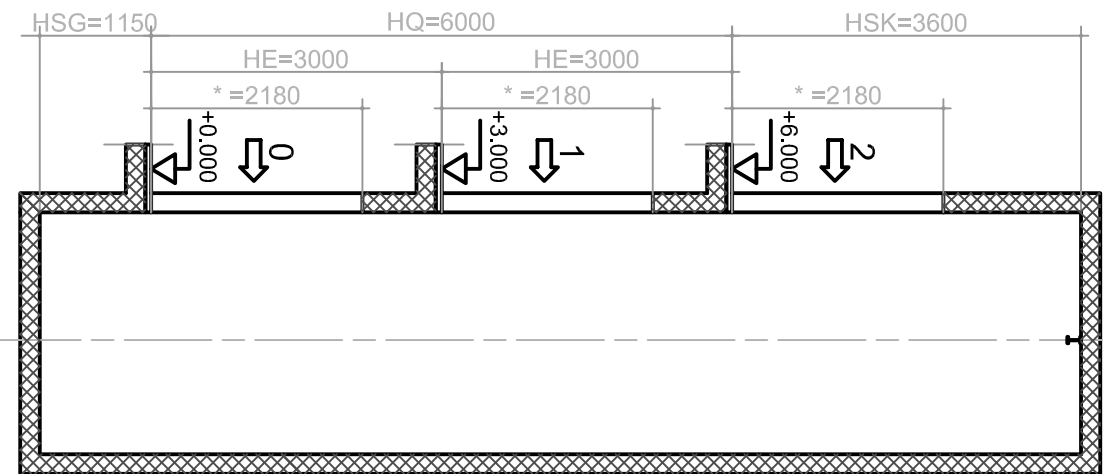
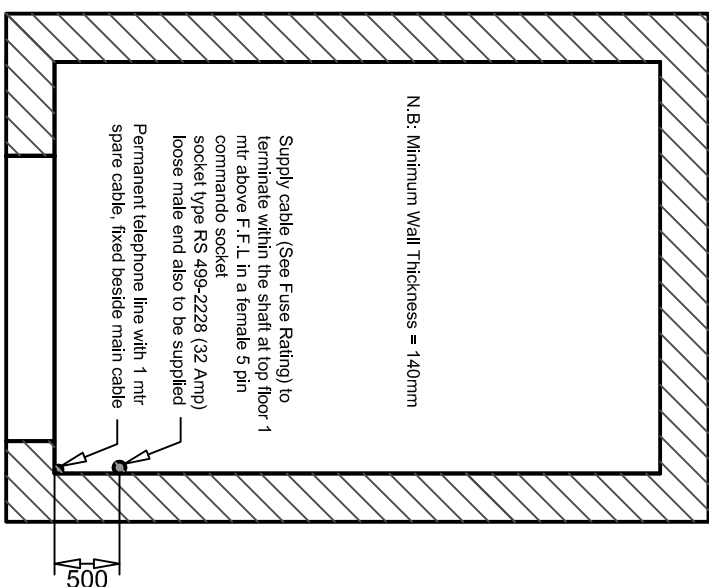

Scale: 1:30
Electrical Plan

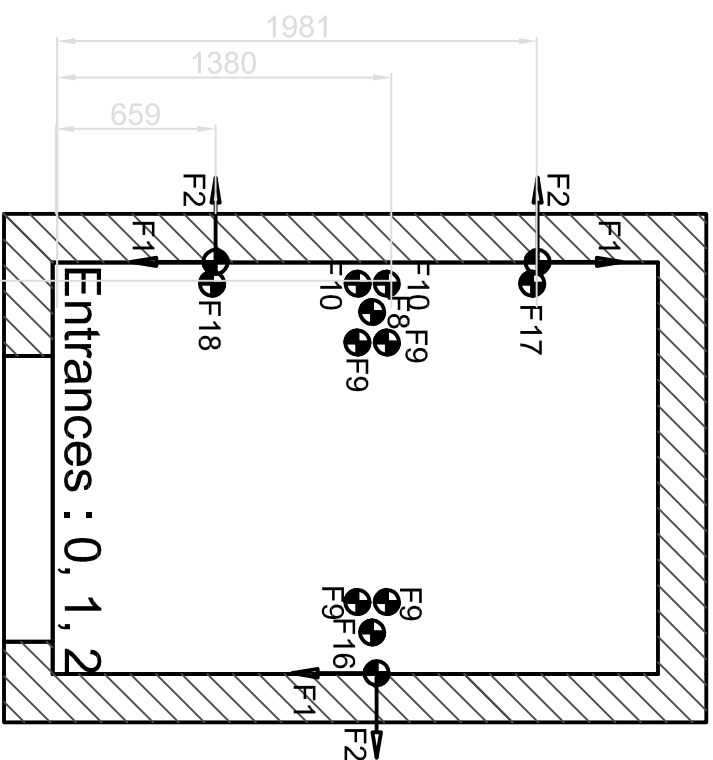

Scale: 1:30
Loadings On Pit & Well Walls

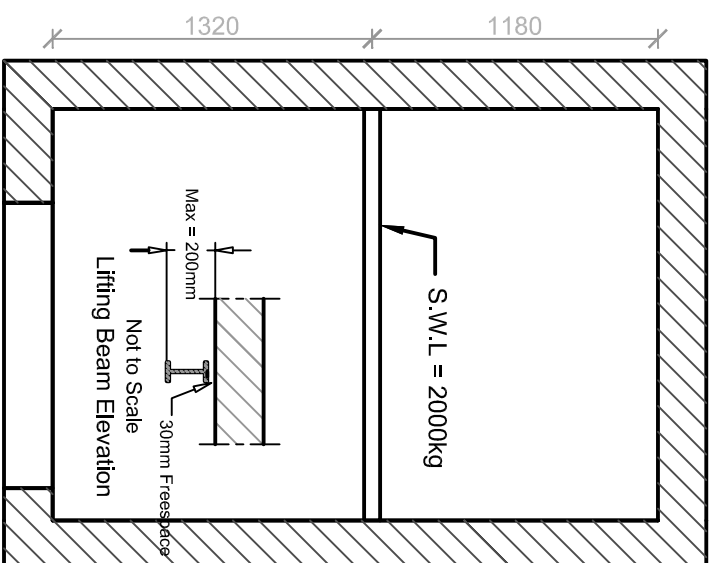

Scale: 1:30
Plan of lifting beam

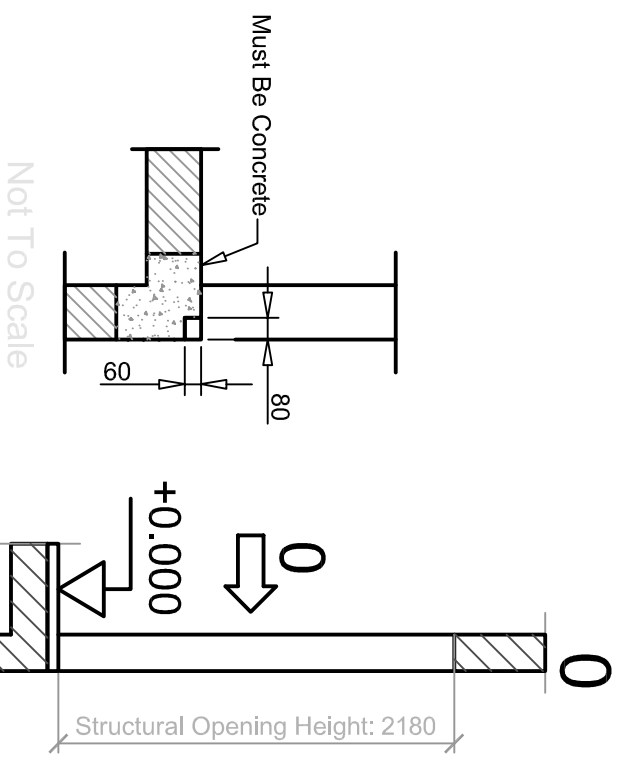

Scale: 1:40
Recess Detail (At All Floors)
Wall Openings

Other technical data: look up "Builders responsibilities"

Ind.	Modification	Name	Date

Loads (N)

F1 = 1095	F5 =	F9 = 20600	F13 =	F17 = 17000
F2 = 1557	F6 =	F10 = 30200	F14 =	F18 = 17000
F3 =	F7 =	F11 =	F15 =	
F4 =	F8 = 27700	F12 =	F16 = 57800	

Load F8 in case of operation of the safety gear.
Loads F9 + F10 in case either car or counterweight lands on the buffers.

ELECTRICAL DATA :

Nominal Voltage (V)	3x400 +N+PE	Nom. power of installation SN	7.7
Main frequency (Hz)	50	Main fuse (building) SIH	25
Voltage and frequency deviation	+10/-10 % Min. cross of supply cable		6
Power supply for light (V)	230	Max. length of supply cable	141
Nom. current of installation IIN	22	Total heat generation POW	---
Start. current of installation INA	27		

BUILDER'S WORKPLAN Schindler 3300

Installation place -----

SAMPLE 15 PERSON 1125kg LIFT (900mm Doors)

NOT FOR CONSTRUCTION - Schindler Accept no responsibility for works carried out prior to construction issue drawings

Further inquiries concerning this plan on	Drawn	28/01/2008	A3
Tel: 020 8818 7900 Fax: 020 8818 7879	Comm. No. 5678	Plan No. 201	01